

CROSSWALK @ COURT STREET AND HIGHWAY 299

West Weaverville Paving Project

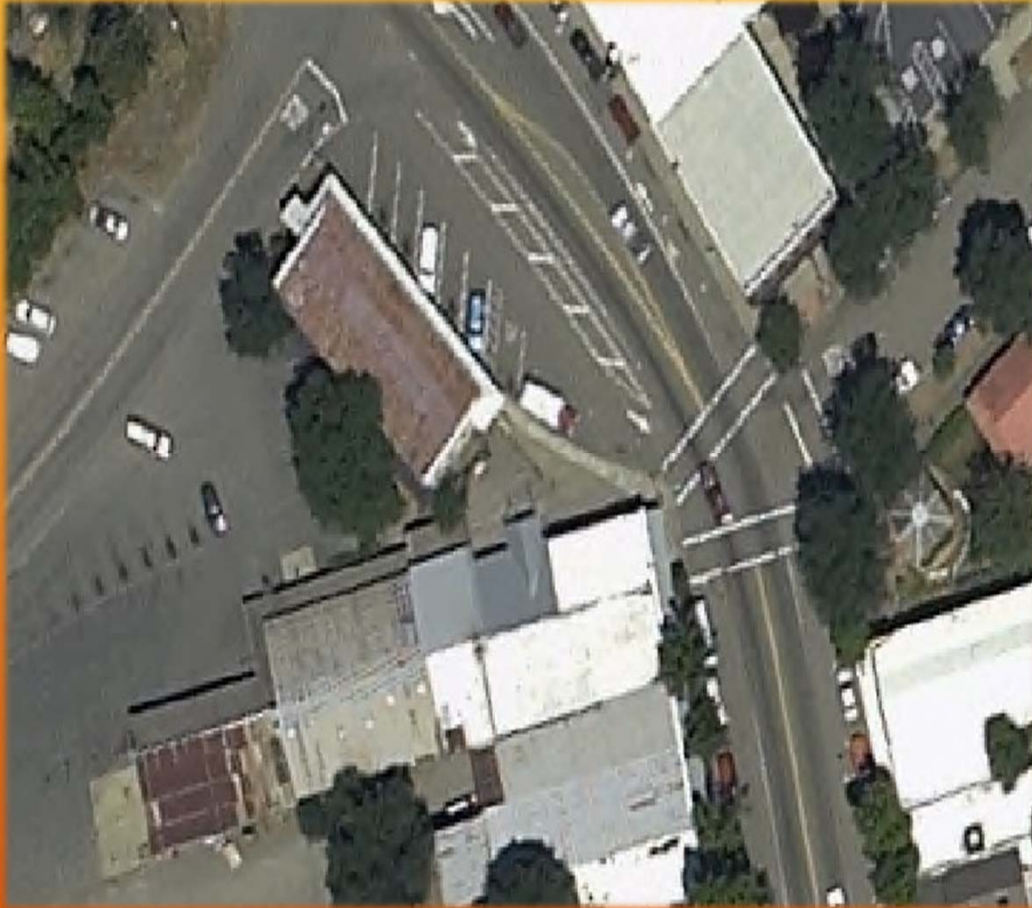

CONFIGURATION PRIOR
TO TRAFFIC CALMING
IMPROVEMENTS



CONFIGURATION TODAY

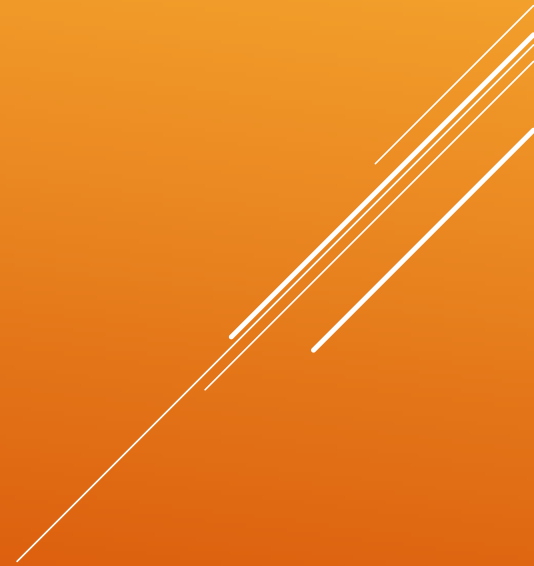

PROPOSED CONFIGURATION

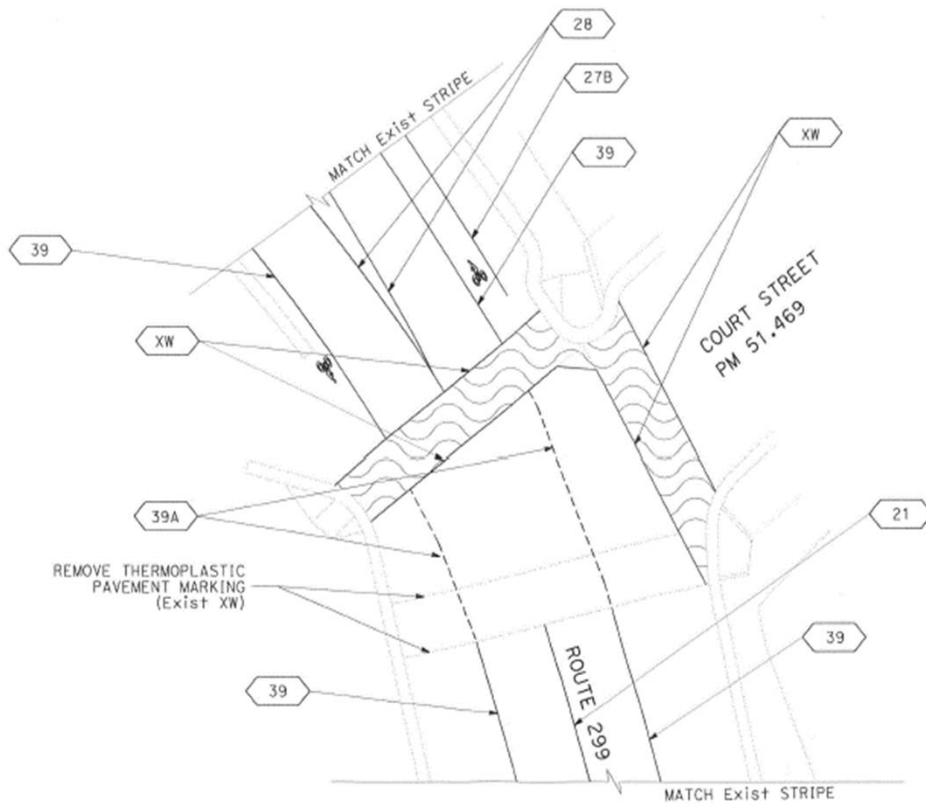

WHAT CHANGED?

- By court order, Caltrans must make curb ramp access to sidewalks compliant with the Americans with Disabilities Act (ADA) standards.
 - The current southern most crosswalk at the intersection of Court Street and Highway 299 has no curb ramp on the southwest side.
 - Because of other conflicts behind the curb (planters, awning posts, and building access), an ADA accessible curb ramp will not fit behind the curb.



WHAT CHANGED?

- After the construction of traffic calming improvements to the west, the view of the crosswalk is now partially blocked if an ADA accessible van is parked to the west, creating a stopping sight distance issue for eastbound traffic.



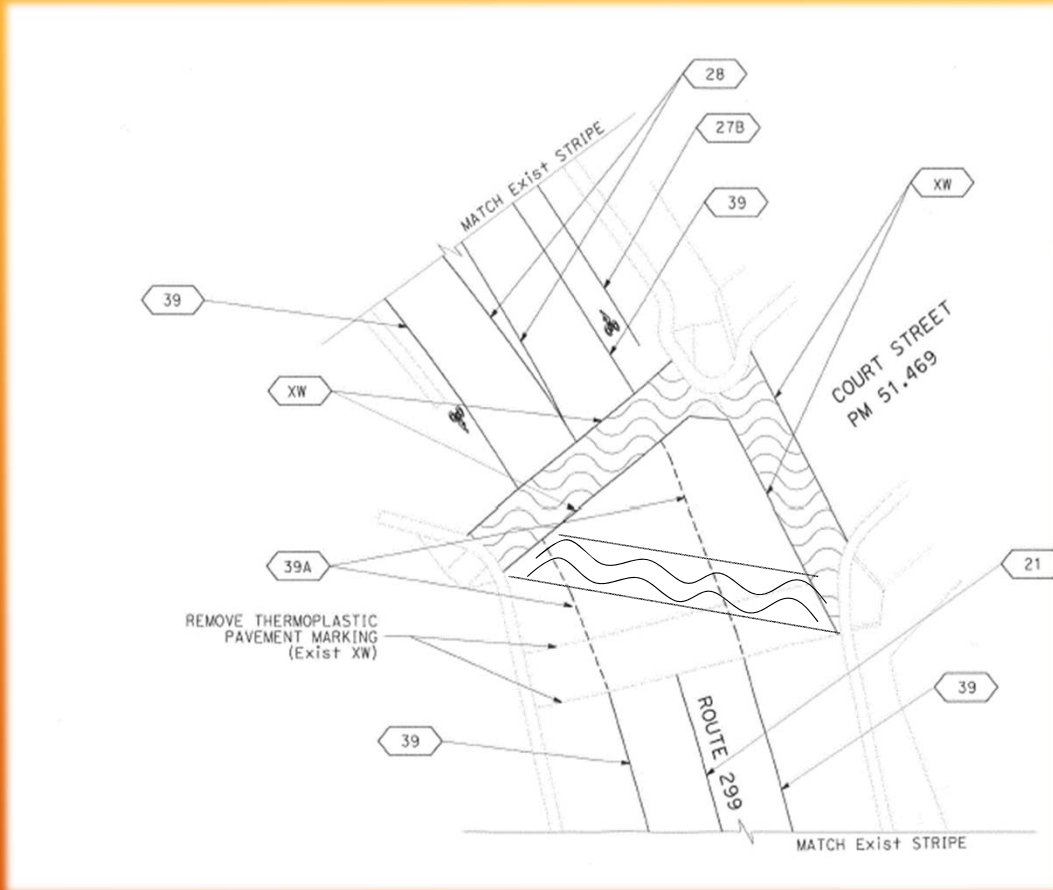

ALTERNATIVES CONSIDERED

- Creates confusion for a pedestrian that is sight impaired.
- Is not standard per the Manual of Uniform Traffic Control Devices and is only allowable at a fully signalized intersection with a phase devoted to pedestrian traffic.

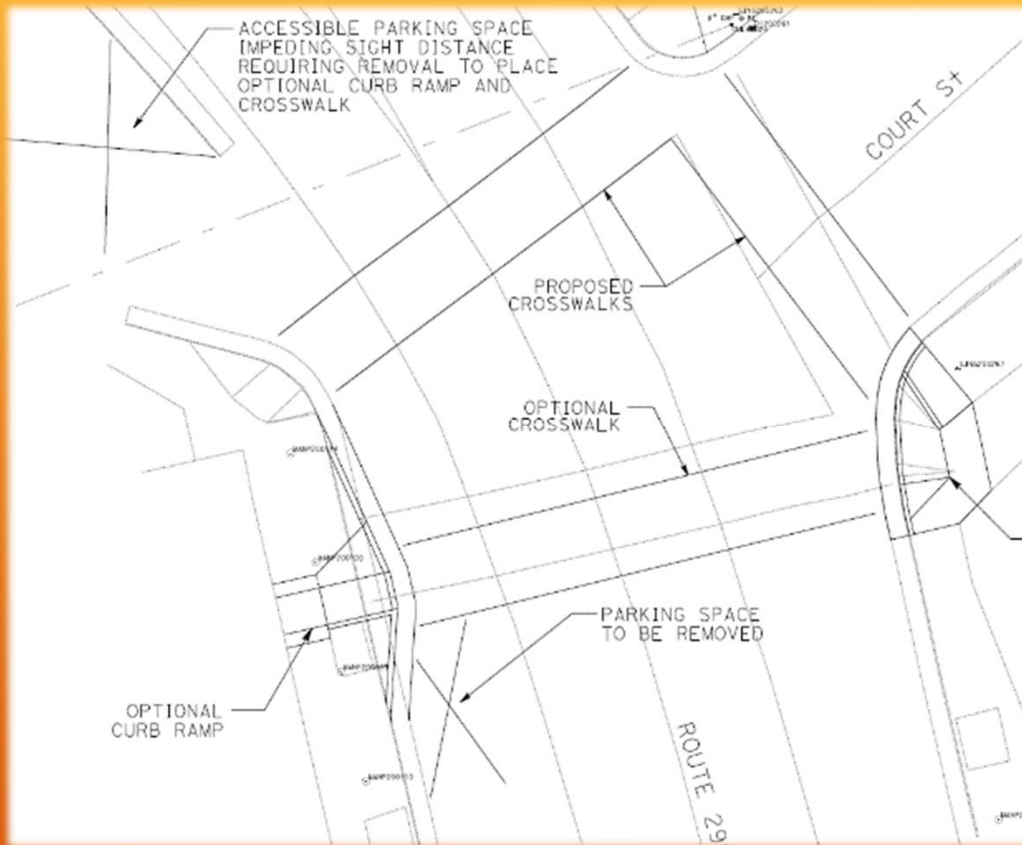

ALTERNATIVES CONSIDERED

- Requires bulb out to accommodate ramp.
- Will require removal of storefront parking stall to accommodate bulb out.
- Will require removal of ADA parking stall at bookstore to provide adequate sight distance.

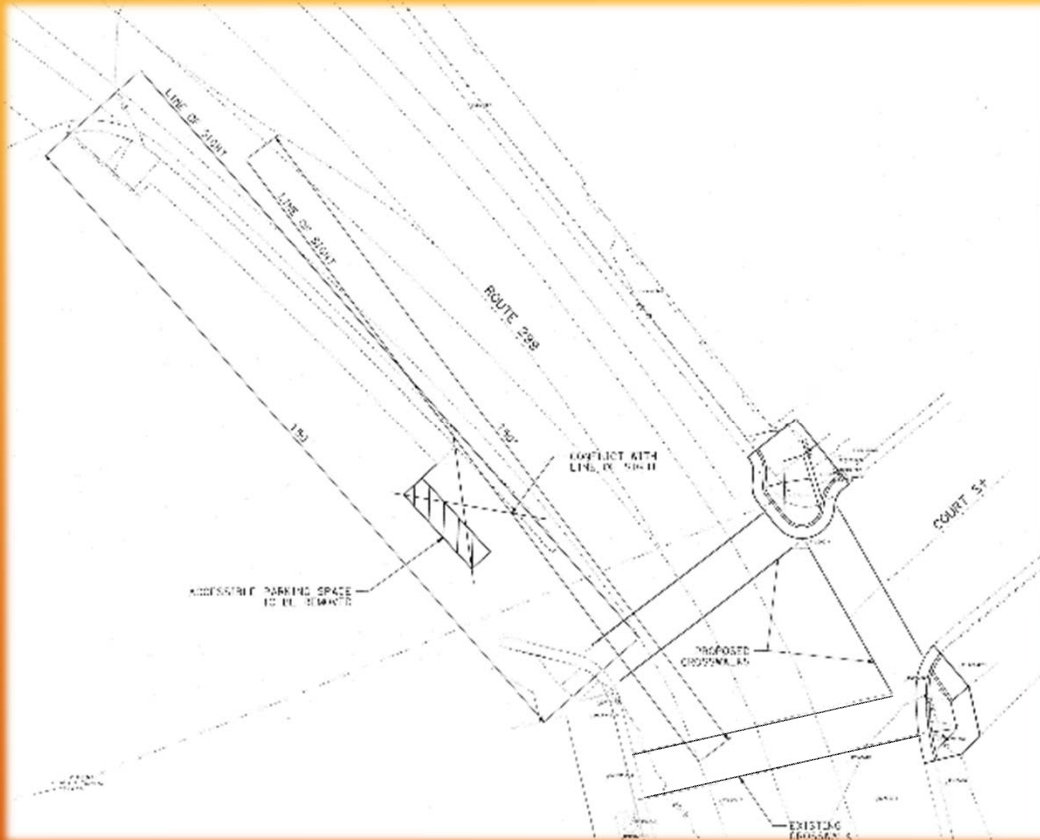

POSSIBLE ALTERNATIVE

- Requires an exception for not providing ADA accessible ramp, which is possible because ADA access is provided by the adjacent crosswalk.
- Will require removal of ADA parking stall at bookstore to provide adequate sight distance, to be removed and relocated by others.